

**From:** [Steve Klotz](#)  
**To:** [Ronsman, Tony R.](#)  
**Subject:** Re: remove from warehouse and install CC137  
**Date:** Wednesday, May 22, 2024 6:09:53 AM  
**Attachments:** [image001.png](#)

---

\$400 to R/D/I. We have wall track to hang the overhead cabinet and have a leg for the corner. The only thing you might want to get is a tackboard for under the cabinet. Thanks!

Steve

Steve Klotz  
Commercial Furniture Specialists Inc.  
Cell: 920-371-6148  
Office: 920-455-1009

On Tuesday, May 21, 2024 at 04:43:48 PM CDT, Ronsman, Tony R. <[tony.ronsman@nwtc.edu](mailto:tony.ronsman@nwtc.edu)> wrote:

Steve,

Can you please provide me with a quote for you to bring ONE workstation back from your warehouse and install it in CC137, per the drawing below? I do not want any cubical walls installed, so please tell me if this is possible because I am concerned about the support at the outer most corner. I would want one 36" wide upper to be attached to the wall on bracket (channel), but I don't know if you have any of those parts. Possibly a BBF, instead of FF ped. The room would need to be painted and carpet replaced before your install, so timeline would be 2<sup>nd</sup> or 3<sup>rd</sup> week in July for the install (for sure install before August 1).

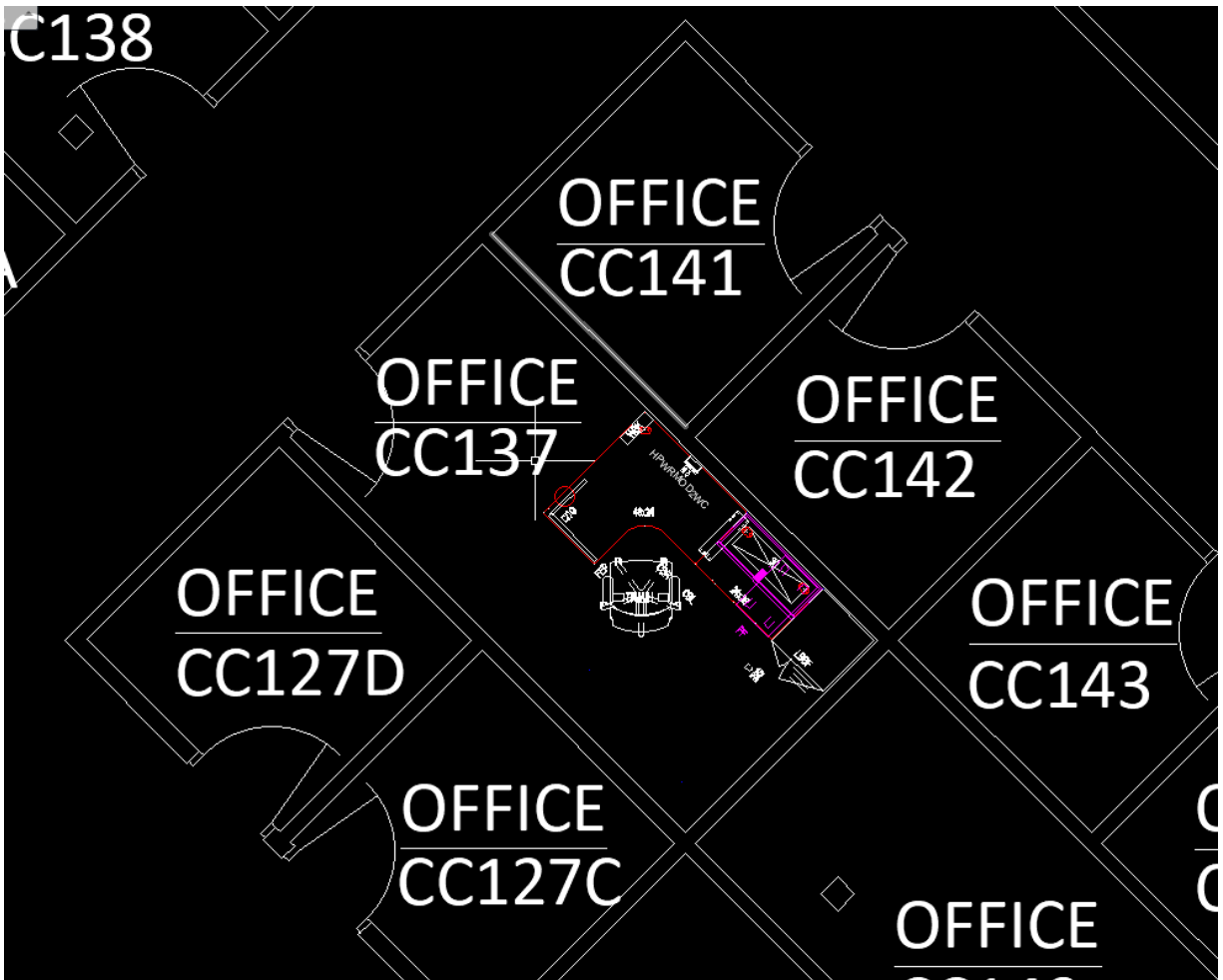

Thanks,

**Tony Ronsman**

CONSTRUCTION PROJECT MANAGER

Northeast Wisconsin Technical College

2740 West Mason Street, Green Bay, WI 54303

Facilities Department – Capital Deployment SC-346

**Mobile** 920-412-9527 | **Office** 920-498-6924

[anthony.ronsman@nwtc.edu](mailto:anthony.ronsman@nwtc.edu) | [nwtc.edu](http://nwtc.edu)



CONFIDENTIALITY: This e-mail (including any attachments) may contain confidential, proprietary and privileged information, and unauthorized disclosure or use is prohibited. If you received this e-mail in error, please notify the sender and delete this e-mail from your system.